

SIGMA-500

Combi Pilot



SIGMA:

The SIGMA line is a complete modular range of reliable equipment for inland shipping and inland fishery. Unique is the combination of digital technology and an analog readout.

Dimming:

The SIGMA-500 display unit is fitted with a dimming system. This unit can be dimmed synchronized with the rest of the Radio Zeeland DMP system. The unit can also be dimmed externally.

Colored lighting:

The scale of the SIGMA-500 display unit is illuminated with LED- backlighting. The color of the lighting can be set to three different colors, Red, Yellow or Blue, creating a night view adjustable to personal preferences.

Additions:

The SIGMA-500 autopilot is a full worthy pilot, but can be expanded if desired. Additional Rate of Turn or Rudder Angle Indicators can be connected, as well as a fluxgate compass, and additional SIGMA-650 units.

Sensors:

As with the SIGMA-550, the SIGMA-500 is connected to the P-503 junction box which is in its turn connected to the S-100 and P-300 sensors for rate of turn and rudder angle indication.

The SIGMA-500 is approved under: R-2-020

SIGMA-500

The SIGMA-500 is Radio Zeeland DMP's compact autopilot. This unit contains a Rate Of Turn indicator and Rudder Angle Indicator in the same housing, saving valuable installation space. The SIGMA-500 operates in combination with the SIGMA-650 control unit. This autopilot is used when there is a lack of installation space in the wheelhouse. The SIGMA-650 steering levers are small enough to even fit in the armrest of your chair, creating flexible and user friendly system.

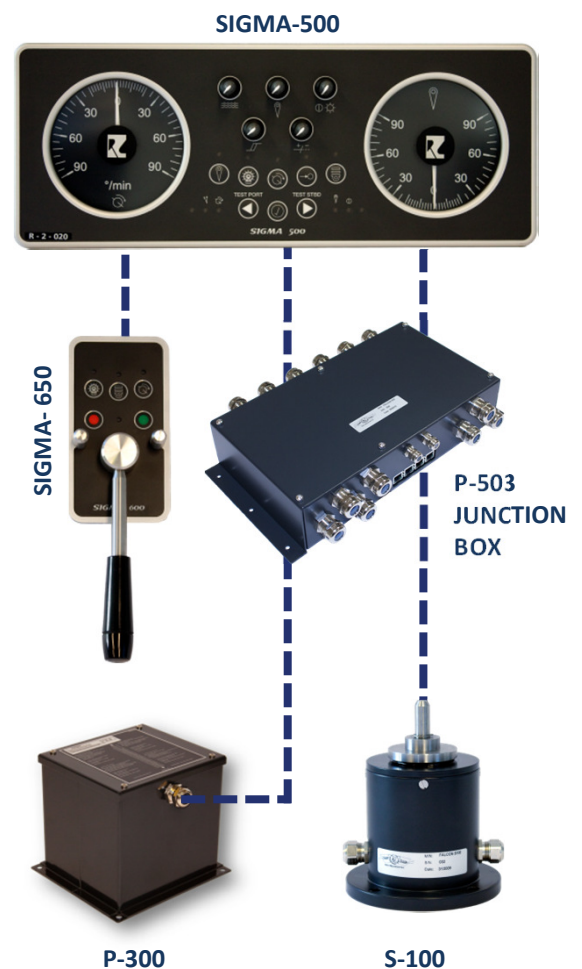

RADIO ZEELAND DMP
www.radiozeeland.com

Technical specifications

Display unit housing specifications

Housing	Clear anodized aluminum
Size	236 x 154 x 80 mm
Weight	Net weight 2,0 kg
Protection	IP-50
Temperature	0 to + 55°C,
Humidity	0 to 90% non-condensing

Electrical specifications

Main power supply	24 Vdc – 10% +30%.
Backup power supply	24 Vdc – 10% +30%.
Amperage	< 1A (without repeaters)
Power consumption	< 1A

Optical specifications

RAI Indicator scale	90° - 0° - 90°
ROT Indicator scale	90° - 0° - 90° (optional: 300° - 0° - 300°)
Dimming range	5 - 100%
Illumination color	Red / Blue / Yellow

Inputs

NMEA in IEC 61162 (HDM or HDT or HDG and VTG)

Outputs

- External dimmer 15VDC PWM with a maximum of 150mA Repeater 0-1mA.
- NMEA out IEC 61162
- Analogue out for 1mA Rudder Angle Indicator
- Analogue out for 1mA Rate Of Turn Indicator

Declaration of conformity

EN 60945 (IEC 945 Third edition: 1996-11) Chapters 9,10,11 and 12

Scope of supply

- SIGMA-500 display unit
- The SIGMA-500 Manual
- SIGMA-650 steering lever
- SIGMA-650 Manual
- P-503 junctionbox
- P-503 Manual
- S-100 Smart Rudder Angle Sensor
- S-100 Manual
- P-300 Smart Gyro Sensor
- P-300 Manual
- Assembly set

Dimensions in mm:

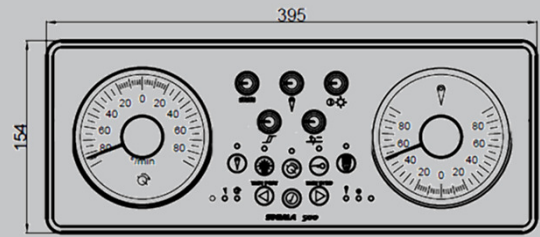

FRONT

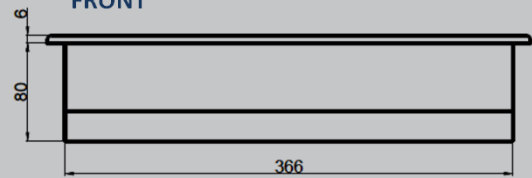

BOTTOM

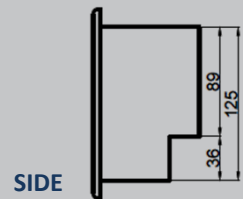

SIDE

P-503 junctionbox

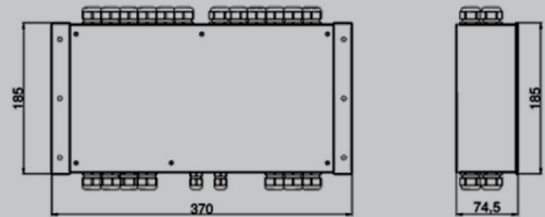

S-100 Sensor

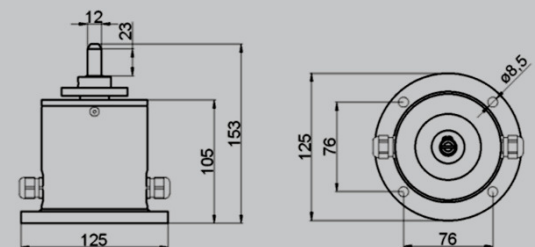

P-300 Sensor

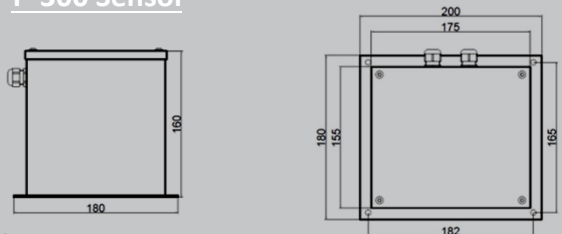

Dealer:

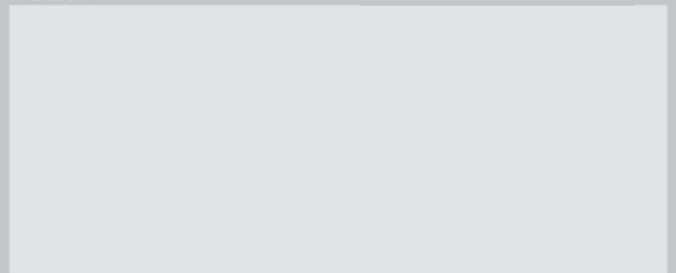

Product is subject to change without notice.